

Orsino Bistro Layout Plan

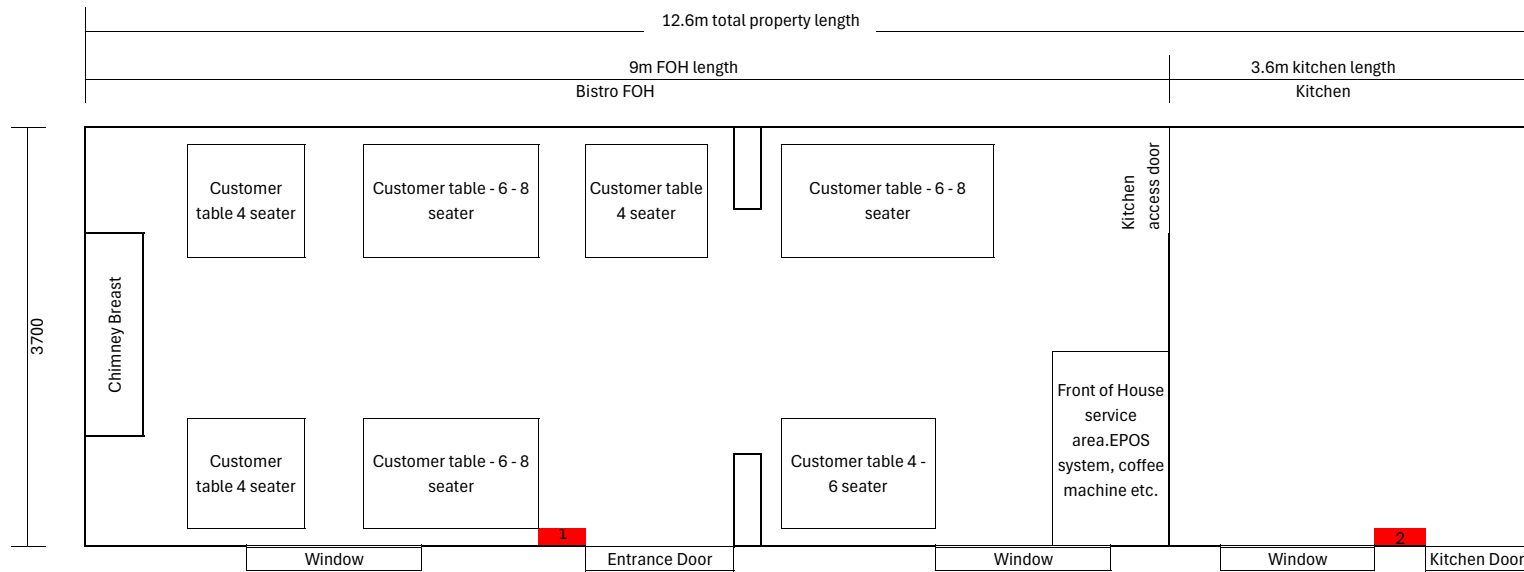

Notes

- N.B. Above plan is not to scale but measurements are correct.
- Bistro will occupy units 11, 12 & 13 on site plan. Unit 11 will be the kitchen and 12 & 13 will be the public Bistro area.
- Building is on one level
- Site entrance and exits are between the WC and unit 1, and to the right of unit 11 which is the Bistro kitchen.
- Unit 2 is occupied as a Barbers but no other units are occupied at present, but the owners have interest from the beautician industry. The agreement is that I will be the only business selling food and drink.
- Fire safety regulations will be adhered to in conjunction with the owners of the property, The relevant fire extinguishers will be in place within the public space. The kitchen area will also have th relevant fire safety equipment for the environmant including electrical fire extinguishers and fire blankets.
Location 1 - Class A & CO2 extinguishers.
Location 2 - Class A, CO2 & fire blanket.
- Please note that there is no gas appliances in the Bistro.

