





REFERENCE

-  APPLICATION BOUNDARY
-  LAND WITHIN THE CONTROL OF THE APPLICANT
-  AREA OF SITE LYING WITHIN CORBY BOROUGH COUNCIL
-  AREA OF SITE LYING WITHIN EAST NORTHAMPTONSHIRE COUNCIL

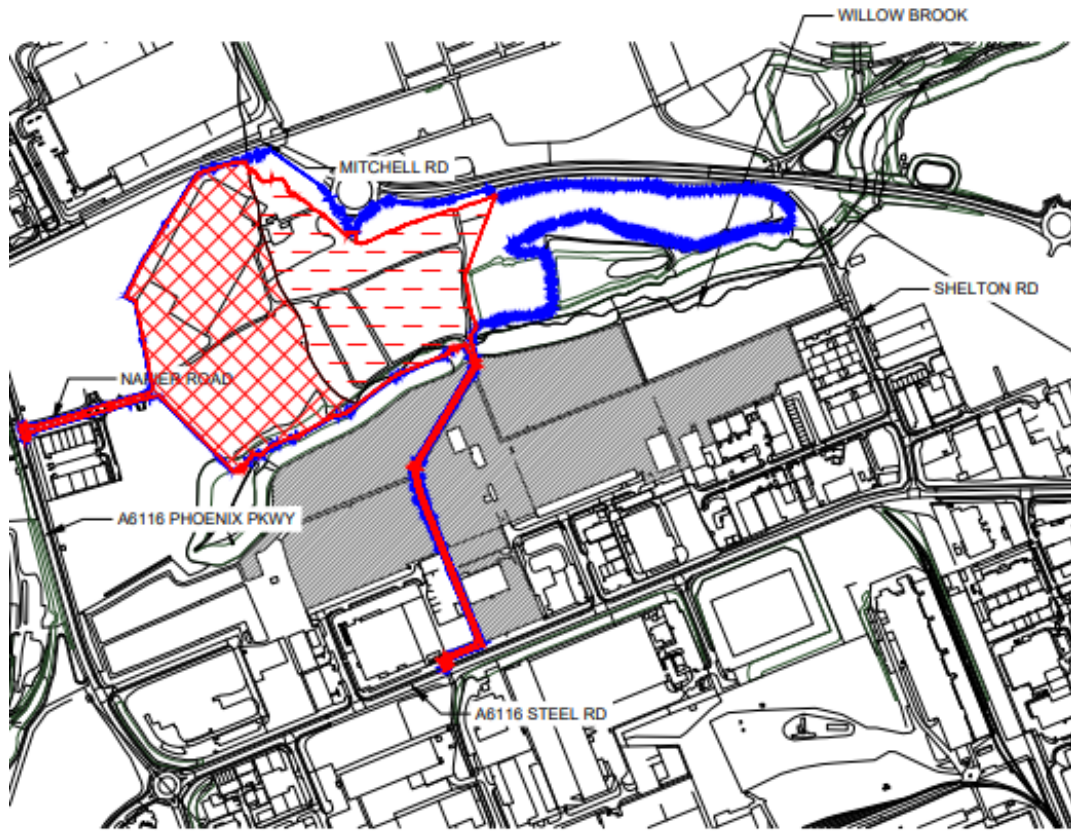

**Storefield Group Limited, Land Off, Centrix Business Park, Napier Road,
Corby, Northamptonshire,
Planning Application Reference: NC/21/00072/OUT
Planning Committee Date: 07.06.2023**

Scale: 1:1250

