

Public Document Pack



Meeting: Licensing Sub-Committee

Date: Tuesday 30th July, 2024

Time: 9.00 am

Venue: Swanspool House, Wellingborough, Northants, NN8 1BP

To members of the Licensing Sub-Committee

Councillors Jonathan Ekins, Anup Pandey and Geoff Shacklock.

Agenda			
Item	Subject	Presenting Officer	Page no.
01	Election of chair for the meeting		
02	Apologies for absence		
03	Declarations of Interest (if any)		
04	Application for a Variation to the Premises Licence for The White Hart Tavern, High Street, Corby, NN17 1UX	Rita Groves. Licensing Enforcement Officer	5 - 44
05	Close of business		
<p>Sanjit Sull, Monitoring Officer North Northamptonshire Council</p> <p>Proper Officer 19 July 2024</p>			

This agenda has been published by Democratic Services.

Committee Administrator: Carol Mundy

☎ 01933 231 521

✉ Carol.Mundy@northnorthants.gov.uk

Meetings at the Council Offices

Where there is a need for the council to discuss exempt or confidential business, the press and public will be excluded from those parts of the meeting only and will have to vacate the room for the duration of that business.

Press & Media Enquiries

Any press or media enquiries should be directed through the council's Communications Team to media@northnorthants.gov.uk

Public Enquiries

Public enquiries regarding the authority's meetings can be made to democraticservices@northnorthants.gov.uk

Members' Declarations of Interest

Members are reminded of their duty to ensure they abide by the approved Member Code of Conduct whilst undertaking their role as a Councillor. Where a matter arises at a meeting which **relates to** a Disclosable Pecuniary Interest, you must declare the interest, not participate in any discussion or vote on the matter and must not remain in the room unless granted a dispensation.

Where a matter arises at a meeting which **relates to** other Registerable Interests, you must declare the interest. You may speak on the matter only if members of the public are also allowed to speak at the meeting but must not take part in any vote on the matter unless you have been granted a dispensation.

Where a matter arises at a meeting which **relates to** your own financial interest (and is not a Disclosable Pecuniary Interest) or **relates to** a financial interest of a relative, friend or close associate, you must disclose the interest and not vote on the matter unless granted a dispensation. You may speak on the matter only if members of the public are also allowed to speak at the meeting.

Members are reminded that they should continue to adhere to the Council's approved rules and protocols during the conduct of meetings. These are contained in the Council's approved Constitution.

If Members have any queries as to whether a Declaration of Interest should be made please contact the Monitoring Officer at – monitoringofficer@northnorthants.gov.uk

This page is intentionally left blank

Licensing Sub-Committee 30 July 2024

Report Title	Application for a Variation to the Premises Licence for The White Hart Tavern, High Street, Corby, NN17 1UX.
Report Author	Iain Smith Assistant Director of Regulatory Services Iain.Smith@northnorthants.gov.uk

List of Appendices

- Appendix 1 – Premises Licence Application
- Appendix 2 – Plan of Premises
- Appendix 3 – Current Premises Licence
- Appendix 4 – Valid Representations
- Appendix 5 - Email summary of incident from police
- Appendix 6 – Map of Area
- Appendix 7 – Map of Area

1. Purpose of Report

- 1.1. To obtain the Sub-Committee's decision in respect of an application for a full variation to the premises licence for The White Hart Tavern, High Street, Corby, NN17 1UX.

2. Executive Summary

- 2.1. The council has received an application for a full variation to the premises licence for The White Hart Tavern, High Street, Corby, NN17 1UX.
- 2.2. The appropriate notices were displayed and the advertisement was placed as required. Three valid representations were received and therefore the report invites the Sub-Committee to determine the application.

3. Recommendations

- 3.1. The Sub-Committee is asked to consider the variation to the premises licence application.
- 3.2. Each application must be considered on its own merits and any conditions attached to licences and certificates must be tailored to the individual style and characteristics of the premises and events concerned. This is essential to avoid the imposition of disproportionate and overly burdensome conditions on premises where there is no need for such conditions. Standardised conditions

should be avoided and indeed, may be unlawful where they cannot be shown to be necessary for the promotion of the licensing objectives in any individual case.

4. Report Background

4.1. The application requests to allow a licensable activity to take place in an existing Licensed Premises. The application form and plan can be seen at **Appendix 1** and **Appendix 2**. The current Premises Licence is included within **Appendix 3**.

4.2. The matters for which the variation is sought are detailed below:

Sale of alcohol for consumption off the premises:

Sunday to Thursday 10:00 – 00:00

Friday to Saturday 10:00 – 03:00

Opening Hours:

Sunday to Thursday 10:00 – 00:00

Friday to Saturday 10:00 – 03:00

4.3. The application also seeks to include outdoor music for the garden area.

4.4. During the consultation period, one representation was received from the Police, concerning the conditions on the licence, the Police requested their model conditions be attached to the Premises Licence, which was accepted by the applicants, so they withdrew their objection.

4.5. A local resident submitted a representation concerning the operating hours. Following consultation with the applicants, the applicants offered a 02.00 hours finish which the objector accepted, so the objectors withdrew their representation.

4.6. Four further objections were received, one from the Corby Old Village Neighbourhood Association and three from residents. One of the resident objections was anonymous, and they did not want their details shared, so this representation was not deemed to be valid. There are therefore three valid representations for consideration and these can be seen at **Appendix 4**.

4.7. The representations are concerned with Public Nuisance caused by noise and Crime and Disorder caused by possible anti-social behaviour.

4.8. In one of the representations an incident outside the premises is raised. Enquiries with the police show that at approx. 00:30hrs on the 19/05/2024 a report was made to the Police regarding this incident. An email from David Bryan is attached as **Appendix 5** which provides a summary of the incident. This summary was sent to the objectors for comment and responses are shown in the relevant sections of **Appendix 4**.

4.9. Maps of the area showing The White Hart in relation to the two representation addresses in the High Street, Corby can be seen at **Appendix 6** and **Appendix 7**.

5. Issues and Choices

5.1. Determination

5.1.2 The Sub-Committee must carry out its functions to promote the licensing objectives having regard to:

- The Licensing Act 2003
- The Council's Licensing Policy
- S182 Guidance

5.1.3 The Act states that the hearing shall have regard to the representations and following a hearing the Sub-Committee may take any of the following actions if they deem them necessary to promote the licensing objectives:

- Grant the licence subject to the operating schedule and mandatory conditions only
- Grant, subject to further conditions necessary for the promotion of the licensing objectives
- Refuse the application in its entirety
- Refuse elements of the application

5.2. Policy Considerations

5.2.1 This section highlights the elements of the licensing policy that are most relevant with respect to this application. This is not exhaustive and the policy should be considered fully prior to making decisions with respect to applications: -

- *2.12 This Licensing Authority will also have regard to wider considerations affecting the residential population and the amenity of any area. These include littering, fouling, noise and street crime.*
- *2.13 In determining a licence application the overriding principle adopted by the Licensing Authority will be that each application will be determined on its merits. Only mandatory conditions and conditions relevant to the operating plan will be imposed except where relevant representations against an application are received. Where relevant representations are received then further additional conditions to meet the licensing objectives may be added provided, they are appropriate, proportionate and reasonable and deal with the issues raised. Licence conditions will not be imposed where other regulatory regimes provide sufficient protection to the public (e.g. Health and Safety at Work and Fire Safety legislation).*

5.3 Section 182 Guidance Considerations

5.3.1 Section 9.31 to 9.41 highlights the elements of section 182 Licensing Guidance that are most relevant with respect to this application. This is not exhaustive and guidance should be considered fully prior to making decisions with respect to applications.

6. Next Steps

- 6.1. Once the Sub-Committee have determined whether to grant, refuse or amend the variation of The White Hart Tavern premises licence application, a decision notice will be sent to the applicant confirming the decision.

7. Implications (including financial implications)

7.1 Resources and Financial

- 7.1.1 There are no resource or financial implications arising from the proposals at this stage.

7.2 Legal and Governance

- 7.2.1 The Licensing Act 2003 makes it a duty for the local authority to carry out its functions under the Act with a view to promoting the four licensing objectives:

- The prevention of crime and disorder
- Public safety
- The prevention of public nuisance, and
- The protection of children from harm

In carrying out its licensing functions, a licensing authority must also have regard to—

- (a) its licensing statement published under section 5, and
(b) any guidance issued by the Secretary of State under section 182.

- 7.2.2 The Licensing Act 2003 sets out how an application for a Premises Licence should be dealt with where valid representations have been submitted. The Sub-Committee must decide the outcome of the application taking into account the Licensing Objectives.

- 7.2.3 In accordance with the provisions of the Act, if a Licensing Authority rejects in whole or in part, an application to grant a Premises Licence the applicant may appeal against the decision.

- 7.2.4 An appeal must be made to the magistrates' court and must be commenced by notice of appeal given by the appellant to the magistrates' court within the period of 21 days beginning with the day on which the appellant was notified by the licensing authority of the decision appealed against.

- 7.2.5 Members are reminded that to satisfy Article 6(1) of the Human Rights Act 1998 they should give written reasons for decisions refusing or revoking licences. Reasons need not be fully detailed but must be sufficiently clear to enable the recipient to exercise any statutory right of appeal.

7.3 Relevant Policies and Plans

- 7.3.1 The North Northamptonshire Council Licensing Act 2003 Statement of licensing policy for regulated entertainment, late night refreshment and the sale of alcohol 2022 – 2027, assists the council in meeting stated commitments within the Corporate Plan.

7.3.2 Relevant section of the Corporate Plan is:

- Creating safe and thriving places

7.4 Risk

7.4.1 There are no significant risks arising from the proposed recommendations in this report.

7.5 Consultation

7.5.1 The consultation process has been carried out in accordance with the requirements of the Licensing Act 2003 and associated guidance.

7.6 Consideration by Executive Advisory Panel

7.6.1 This report has not been considered by the Executive Advisory Panel

7.7 Consideration by Scrutiny

7.7.1 This is not a matter for the Scrutiny Committee.

7.8 Equality Implications

7.8.1 There are no equality implications arising from the proposed recommendations in this report.

7.9 Climate Impact

7.9.1 There are no climate / environmental impacts that may arise regarding this report.

7.10 Community Impact

7.10.1 The licensing regime seeks to minimise any negative community impacts as its purpose is to promote the licensing objective which includes prevention of crime and disorder, prevention of public nuisance, public safety and the protection of children from harm.

7.11 Crime and Disorder Impact

7.11.1 This report is being considered by the Sub Committee to reduce Crime and Disorder within the Council district.

8 Background Papers

Licensing Act 2003

[Licensing Act 2003 \(legislation.gov.uk\)](https://www.legislation.gov.uk)

Revised Guidance under Section 182 of Licensing Act 2003

[Revised guidance issued under section 182 of Licensing Act 2003 - GOV.UK \(www.gov.uk\)](https://www.gov.uk)

Statement of Licensing Policy (2022 to 2027)

[Licensing policy | North Northamptonshire Council \(northnorthants.gov.uk\)](https://www.northnorthants.gov.uk)

This page is intentionally left blank

Appendix Application to vary a premises licence under the Licensing Act 2003 NNC

PLV609315404 | 2024-04-26 13:02:25

Do you agree with the data protection agreement?: I agree

Premises trading name: The white hart tavern

Premises licence number: 15/00781/LAPNEW

Does the premises have a postcode?: Yes

Premises address:

Do you wish to manually enter the address?	Postcode	Address	Address line 1	Address line 2	Address line 3	Postcode
No	NN17 1UX	White Hart Tavern, The White Hart, High Street	White Hart Tavern, The White Hart, High Street		Corby	NN17 1UX

Premises telephone number: 01536264676

Non-domestic rateable value of premises: 11200

Property band: Band B (£4301.00 to £33,000.00)

Have you been advised by us that you may off-set the cost of a minor variation application fee? : No

Applicant's full name: Mr Glen McClintock

Is your current residential address different to premises address?: No

Telephone number: [REDACTED]

Email address: [REDACTED]

Are there other applicants?: No

Do you want the proposed variation to have effect as soon as possible?: Yes

Do you want the proposed variation to have effect in relation to the introduction of the late-night levy?: Yes

I am seeking to vary the licence in relation to the effect of a late night levy only: No

Please describe briefly the nature of the proposed variation: would like to extend opening hours and add outdoor music license to include [REDACTED] area

Would you like to vary the operating schedule conditions?:No

Are you wishing to vary the capacity?:No

Are you looking to vary the site plan?:No

Please complete those parts of the operating schedule below which would be subject to change if this application to vary is successful: Supply of Alcohol

Are there any adult entertainment or services, activities, other entertainment or matters ancillary to the use of the premises that may give rise to concern in respect of children?: No

Will the supply of alcohol be of consumption on premises, off the premises or both?:On the premises

Please give any additional relevant information for the activity:would like to open earlier and close later to capitalise our revenue due to the current financial climate

What days will your activity take place?:Friday, Saturday

Friday - Start and end times:

Start time	End time
10:00	03:00

Saturday - Start and end times:

Start time	End time
10:00	03:00

State any seasonal variations for supply of alcohol (where additional days to the standard days are required for a short period for example during summer months): not applicable

Please state any non-standard timing where you intend to use the premises for supply of alcohol at different times to those listed (where you wish the activity to go on longer than the standard hours for a particular day or days e.g. Christmas Eve) : not applicable

What days will your premises be open to the public?:Monday, Tuesday, Wednesday, Thursday, Friday, Saturday, Sunday

Monday - Start and end times:

Start time	End time
10:00	00:00

Tuesday - Start and end times:

Start time	End time
10:00	00:00

Wednesday - Start and end times:

Start time	End time
10:00	00:00

Thursday - Start and end times:

Start time	End time
10:00	00:00

Friday - Start and end times:

Start time	End time
10:00	03:00

Saturday - Start and end times:

Start time	End time
10:00	03:00

Sunday - Start and end times:

Start time	End time
10:00	00:00

What evidence of the current premises licence are you providing?: Relevant part of the premises licence

Please upload the premises licence: IMG_20240426_105412.jpg

Correspondence first name: Glen

Correspondence last name: McClintock

Correspondence postal address:

Do you wish to manually enter the address?	Postcode	Address	Address line 1	Address line 2	Address line 3	Postcode
No	NN17 1UX	White Hart Tavern, The White Hart, High Street	White Hart Tavern, The White Hart, High Street		Corby	NN17 1UX

Email address: [REDACTED]

Telephone number: [REDACTED]

I confirm I have checked my application prior to submission and confirm the timings and activities that I have requested are those intended : I confirm

I understand that this application and supporting documents will be sent to the responsible authorities and a redacted version will be published on the council's website : I understand

I understand that I must advertise my application : I understand

I understand that if I do not comply with all requirements my application will be rejected : I understand

It is an offence, under section 158 of the licensing act 2003, to make a false statement in or in connection with this application. Those who make a false statement may be liable on summary conviction to a fine of any amount. : I declare

Name: Mr Glen McClintock

Capacity: owner

Secondary applicant - name: Mrs Jeri McClintock

Secondary applicant - capacity: owner

Date : 2024-04-26

Total amount to pay today: 190.00

PrepaymentTimeStamp: 26/04/2024 14:01:26

Transaction status: successful

PostpaymentTimeStamp: 26/04/2024 14:02:23

transaction_reference: 770040768

BUILDING SURVEYED AREA = 357.3 SQ. M
■ LOCATED IN CELLAR
■ LOCATED IN CELLAR
SCALE 1:100
GROUND FLOOR

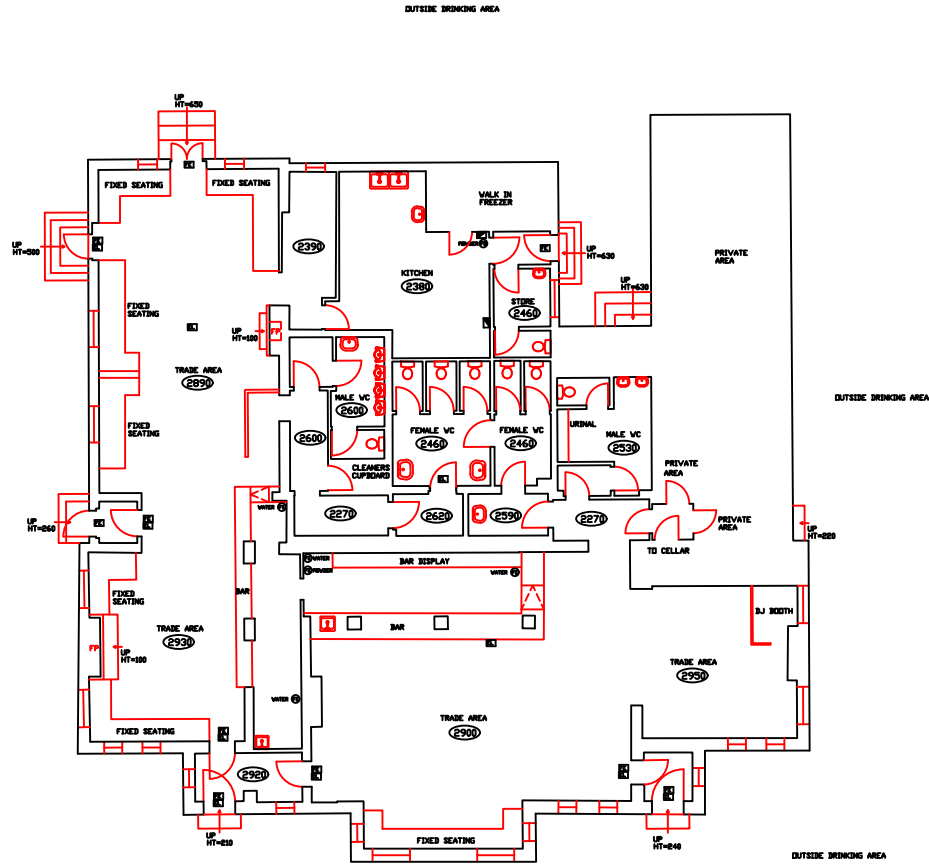

This page is intentionally left blank



Part A: Premises Licence

Premises Licence Number	15/00781/LAPNEW
--------------------------------	-----------------

Part 1 – Premises Details

Postal address of premises, or if none, ordnance survey map reference or description:

The White Hart
High Street
Corby
Northamptonshire
NN17 1UX

Telephone Number:

Licensable activities authorised by the licence and the times the licence authorises the carrying out of licensable activities

Sale of Alcohol

Alcohol consumed off and on premises

Monday to Sunday 11:00 - 00:00

Non Standard Timings

New Year's Eve 11:00 - 01:00

Friday - Monday of Bank Holiday weekends, Christmas Eve and Boxing Day 11:00 - 01:00

Live Music

Indoors

Friday and Saturday 20:00 - 23:00

Recorded Music

Indoors

Monday to Sunday 20:00 - 23:00

Indoor Sporting Events

Monday to Sunday 20:00 - 23:00

Non-standard Openings

-

The opening hours of the premises

Monday to Sunday 11:00 - 00:30

Non Standard Timings

New Year's Eve 11:00 - 01:30

Friday - Monday of Bank Holiday weekends, Christmas Eve and Boxing Day
11:00 - 01:30

Where the licence authorises supplies of alcohol whether these are on and / or off supplies

Alcohol is supplied for consumption both on and off the premises

If this premises licence authorises the supply of alcohol, the following conditions must be complied with:

1. No supply of alcohol may be made under the premises licence—
 - (a) at a time when there is no designated premises supervisor in respect of the premises licence, or
 - (b) at a time when the designated premises supervisor does not hold a personal licence or his personal licence is suspended.
2. Every supply of alcohol under the premises licence must be made or authorised by a person who holds a personal licence
3. The responsible person must ensure that staff on relevant premises do not carry out, arrange or participate in any irresponsible promotions in relation to the premises.

In this paragraph, an irresponsible promotion means any one or more of the following activities, or substantially similar activities, carried on for the purpose of encouraging the sale or supply of alcohol for consumption on the premises—

- (a) games or other activities which require or encourage, or are designed to require or encourage, individuals to—
 - (i) drink a quantity of alcohol within a time limit (other than to drink alcohol sold or supplied on the premises before the cessation of the period in which the responsible person is authorised to sell or supply alcohol), or
 - (ii) drink as much alcohol as possible (whether within a time limit or otherwise);
- (b) provision of unlimited or unspecified quantities of alcohol free or for a fixed or discounted fee to the public or to a group defined by a particular characteristic in a manner which carries a significant risk of undermining a licensing objective;
- (c) provision of free or discounted alcohol or any other thing as a prize to encourage or reward the purchase and consumption of alcohol over a period of 24 hours or less in a manner which carries a significant risk of undermining a licensing objective;
- (d) selling or supplying alcohol in association with promotional posters or flyers on, or in the vicinity of, the premises which can reasonably be considered to condone, encourage or glamorise anti-social behaviour or to refer to the effects of drunkenness in any favourable manner;
- (e) dispensing alcohol directly by one person into the mouth of another (other than where that other person is unable to drink without assistance by reason of disability).

4. The responsible person shall ensure that free potable water is provided on request to customers where it is reasonably available.
5. The premises licence holder or club premises certificate holder must ensure that an age verification policy is adopted in respect of the premises in relation to the sale or supply of alcohol.
6. The designated premises supervisor in relation to the premises licence must ensure that the supply of alcohol at the premises is carried on in accordance with the age verification policy.

The policy must require individuals who appear to the responsible person to be under 18 years of age (or such older age as may be specified in the policy) to produce on request, before being served alcohol, identification bearing their photograph, date of birth and either—

- (a) a holographic mark, or
- (b) an ultraviolet feature.

7. The responsible person must ensure that—

(a) where any of the following alcoholic drinks is sold or supplied for consumption on the premises (other than alcoholic drinks sold or supplied having been made up in advance ready for sale or supply in a securely closed container) it is available to customers in the following measures—

- (i) beer or cider: ½ pint;
- (ii) gin, rum, vodka or whisky: 25 ml or 35 ml; and
- (iii) still wine in a glass: 125 ml;

(b) these measures are displayed in a menu, price list or other printed material which is available to customers on the premises; and

(c) where a customer does not in relation to a sale of alcohol specify the quantity of alcohol to be sold, the customer is made aware that these measures are available.

8. A relevant person shall ensure that no alcohol is sold or supplied for consumption on or off the premises for a price which is less than the permitted price.

If this premises licence authorises the exhibition of films, the admission of children to the exhibition of any film must be restricted in accordance with this condition

9. Where the film classification body is specified in the licence, unless section b) below applies, admission of children must be restricted in accordance with any recommendation made by that body.

Where—

- (a) the film classification body is not specified in the licence, or
- (b) the relevant licensing authority has notified the holder of the licence that this subsection applies to the film in question,

admission of children must be restricted in accordance with any recommendation made by that licensing authority.

If this premises licence requires the use of door supervisors.

10. Where the premises licence includes a condition that at specified times one or more individuals must be at the premises to carry out a security activity, each such individual must

- (a) be authorised to carry out that activity by a licence granted under the Private Security Industry Act 2001; or

- (b) be entitled to carry out that activity by virtue of section 4 of that Act.

Note: This does not apply to premises with premises licences authorising plays or films, premises exclusively used by a club with club premises certificate, under a temporary event notice authorising plays or films or under a gaming licence .

Explanatory Notes and Definitions for Mandatory Condition 8.

Definitions

“duty” is to be construed in accordance with the Alcoholic Liquor Duties Act 1979;

“permitted price” is the price found by applying the formula—

$$P = D + (D \times V)$$

where—

- (i) P is the permitted price,
- (ii) D is the rate of duty chargeable in relation to the alcohol as if the duty were charged on the date of the sale or supply of the alcohol, and
- (iii) V is the rate of value added tax chargeable in relation to the alcohol as if the value added tax were charged on the date of the sale or supply of the alcohol;

“relevant person” means, in relation to premises in respect of which there is in force a premises licence—

- (i) the holder of the premises licence,
- (ii) the designated premises supervisor (if any) in respect of such a licence, or
- (iii) the personal licence holder who makes or authorises a supply of alcohol under such a licence;

“valued added tax” means value added tax charged in accordance with the Value Added Tax Act 1994.

Where the permitted price calculated would not be a whole number of pennies, it shall be taken to be the price calculated rounded **up** to the nearest penny.

NOTE: This note is provided to give assistance in calculating prices, it is not a legal document. If you are unsure on any issue related to permitted prices, seek advice. Further information can be found about mandatory conditions can be found at <https://www.gov.uk/alcohol-licensing#mandatory-licensing-conditions>.

Annex 2 – Conditions consistent with the Operating Schedule

General

This will be a family friendly licensed premises with a restaurant, we do not anticipate problems, however we do have fully trained staff securing public safety.

Notices requesting patrons to leave quietly will be at every door to prevent public nuisance.

We will be asking anyone who looks under twenty-five for identification.

We are a member of Pubwatch and a representative attends Pubwatch meetings and participates in all initiatives.

A Personal Licence holder will be at the premises at all times when alcohol is being sold or regulated entertainment is being provided.

We have a policy on the safe management of large groups, i.e. hen and stag parties.

We operate a complete no smoking policy at the premises.

A "Hot Line" to local taxi firms is available.

PREVENTION OF CRIME AND DISORDER.

1. A fully working and maintained CCTV system capable of recording and storing images must be installed on the premises. The system must always record whilst the premises are open to the public and images must be stored for a minimum of 31 days with date & time stamping. As a minimum this must cover all entry and exit points, both sides of all areas where the sale/supply of alcohol takes place.

2. A person conversant with the retrieval and downloading of CCTV must always be present on the premises whilst it is open to the public.

3. All CCTV recordings must be made available to a Police Officer or an Officer from a responsible authority for viewing on request and recordings downloaded upon reasonable request but no later than 48 hours and in line with current Data Protection legislation.

4. SIA Door Supervisor(s) when employed at the premises on Friday and Saturday from 19:00 until the close of business, Door Supervisor(s) shall be employed based upon a documented security risk assessment completed by the Premises Licence Holder and/or the Designated Premises Supervisor. The risk assessment will consider when (Friday/Saturday and any other days and times) the Door Supervisor(s) are employed and the number of Door Supervisor(s) employed.

5. Door Supervisor(s) will be required to record their full SIA Licence number into an incident logbook or equivalent digital recording system when commencing their work at the premises. The incident logbook or equivalent digital recording system will be available for inspection on the request of a Police Constable, an Officer of a

Responsible Authority or a person employed by the Security Industry Authority (SIA).

6) That a Personal Licence Holder be present and working from 07:00pm Fridays and Saturdays, Bank Holiday Sundays, Christmas Eve, Boxing Day, and New Years Eve until the close of business.

7) Any Personal Licence Holder working at the premises shall produce their Personal Licence immediately on request to a Police Officer or an officer of a Responsible Authority.

8) A proof of age scheme, such as Challenge 25 shall be operated at the premises where the only acceptable forms of identification are recognised photographic cards, such as a driving licence, passports, holographic marked PASS scheme identification cards, or HM Forces identification cards.

9) On Friday and Saturday, the last entry time for customers/patrons will be midnight.

10) An incident log shall be kept at the premises and made available on request to an authorised officer of the Council or the Police. It must be completed within 24 hours of the incident and will record the following:

- (a) All crimes reported to the venue
- (b) All ejections of patrons
- (c) Any complaints received concerning crime and disorder
- (d) Any incidents of disorder
- (e) all seizures of drugs or offensive weapons
- (f) any faults in the CCTV system, searching equipment or scanning equipment
- (g) Any refusal of the sale of alcohol
- (h) Any visit by a relevant authority or emergency service

11) No drinks to be consumed in the outside areas after midnight.

Bottles and glasses

12. Alcohol and soft drinks will be served in plastic or toughened glasses.

13. Customers carrying open or sealed bottles or glasses will not be admitted to the premises at any time.

14. Customers will not be permitted to take open containers of alcohol or soft drinks from the premises.

15. All bottles and glasses are to be removed from public areas as soon as the contents have been drunk or are empty.

Capacity Limits

16. We have a capacity limit to prevent overcrowding which could lead to crime and disorder.

17. The capacity limit is based on advice from the Police, Fire Service, and own risk assessment.

19. Door supervisors will ensure the capacity limits are not exceeded, always.

Proof of Age Cards

20. We have a proof of age policy that has been formulated in discussion with the Police and the Licensing Authority.

Drinks Promotions

21. The Designated Premises Supervisor or a Personal Licence holder will oversee the premises when any drinks promotions are taking place.

PUBLIC SAFETY

Fire Safety

22. We have conducted a suitable Fire Risk Assessment at the premises and implemented the necessary control measures.

23. All exit doors are easily operable without the use of a key, card, code or similar means.

24. Records of all these checks are kept and can be produced on request.

25. All removable security fastenings are removed whenever the premises are open to the public or staff.

26. Step and stair edges are appropriately highlighted so as to be conspicuous.

27. Hangings, curtains and temporary decorations are maintained in a flame retardant condition.

28. Upholstered seating is fire retardant and complies with current fire safety regulations.

29. Notices detailing the actions to be taken in the event of fire or other emergency are prominently displayed and maintained in good condition.

30. Access is provided for emergency vehicles and kept clear and free from obstruction at all times.

31. Fire drill and emergency lighting tests are conducted weekly / monthly. Records of these tests are available upon request.

32. All fire exits and means of escape are signed in accordance with BS5499: Part 1: Specification for Fire Safety Signs : 1990.

33. An evacuation policy is in place that is to the satisfaction of the Fire Authority. All staff members have been trained in fire and emergency evacuation procedures.

34. Exit doors open outwards or are secured in the open position if this is not the case.

35. Prominent, clear, and legible notices shall be displayed on all fire exits stating that fire exits are for emergency use only.

First Aid

36. Adequate and appropriate First Aid equipment and materials are available on the premises.

37. At least one suitable trained First Aider will be on duty when the public are present.

38. First Aiders are trained to deal with drug and alcohol related problems.

PREVENTION OF PUBLIC NUISANCE

Noise and vibration

39. Doors and windows will be kept closed when regulated entertainment is taking place.

40. Disposal of empty bottles into waste receptacles outside the premises will not be permitted to take place between the hours of 23:00 hrs and 07:00 hrs to minimise disturbance to nearby occupiers.

41. For the final hours of opening the music is reduced in volume and is discernibly quieter.

42. The playing of live or recorded music in garden or outside seating areas of the premises is not permitted after 2300 hrs.

43. The garden or outside seating areas are closed to the public after 2300 hrs.

44. Signs shall be displayed near the exits reminding members and guests to respect the needs of those living nearby and to leave the premises as quietly as possible.

45. Staff training shall be given and documented regarding control of noise and the related licence conditions. Records of training shall be kept for 3 years.

Litter

46. Litter receptacles are placed outside the premises for customers to use and are emptied at least daily.

47. The premises has a waste collection contract with Biffa who remove waste.

48. Staff undertake a litter pick to a distance of 50 metres around the premises daily.

PROTECTION OF CHILDREN FROM HARM

49. The premises operates a proof of age policy that has been agreed by the police.

The current conditions on the licence in Annex 2 are as follows:

Embedded Conditions Apply (The licence is granted on the condition that the restrictions contained within the enactments specified under Licensing Act 2003 Schedule 8 (6) are adhered to).

The types of regulated entertainments proposed reinstate and then enhance the normal pub entertainments that were previously unregulated, with the benefit to enhance the local facilities for social entertainment and reduce the focus on alcohol.

No new steps have been identified by my risk assessment in relation to the four licensing objectives, except as below.

I have considered the terms of your local licensing policy in preparing this application.

Member of the Corby Pub Watch.

Providing a 30-minute extension of opening hours after the end of the sale of alcohol will promote this objective as the last drink will be consumed less quickly, with access to the pub's toilet facilities.

My risk assessment has identified no risk of crowding.

Live music & recorded music will end at 23:00.

The restrictions set out in the Licensing Act 2003 will apply.

No unusual risks of harm to children have been identified.

Annex 3 – Conditions attached after a hearing by the licensing authority

None

Annex 4 – Plans

Please see attached



Part B Premises Licence Summary

Premises Licence Number	15/00781/LAPNEW
--------------------------------	-----------------

Part 1 – Premises Details

Postal address of premises, or if none, ordnance survey map reference or description:

The White Hart
High Street
Corby
Northamptonshire
NN17 1UX

Telephone Number:

Licensable activities authorised by the licence and the times the licence authorises the carrying out of licensable activities

Sale of Alcohol

Alcohol consumed off and on premises

Monday to Sunday 11:00 - 00:00

Non Standard Timings

New Year's Eve 11:00 - 01:00

Friday - Monday of Bank Holiday weekends, Christmas Eve and Boxing Day 11:00 - 01:00

Live Music

Indoors

Friday and Saturday 20:00 - 23:00

Recorded Music

Indoors

Monday to Sunday 20:00 - 23:00

Indoor Sporting Events

Monday to Sunday 20:00 - 23:00

Non-standard Openings

-

The opening hours of the premises Page 31

Monday to Sunday	11:00 - 00:30
<i>Non Standard Timings</i> New Year's Eve 11:00 - 01:30 Friday - Monday of Bank Holiday weekends, Christmas Eve and Boxing Day 11:00 - 01:30	
Where the licence authorises supplies of alcohol whether these are on and / or off supplies	
Alcohol is supplied for consumption both on and off the premises	

Name, (registered) address of holder of premises licence

Ms Jeri McClintock
■ Finch Hatton Drive
Gretton
Corby
NN17 3DQ
Mr Glen McClintock
■ Finch Hatton Drive
Gretton
Corby
NN17 3DQ

Registered number of holder, for example company number, charity number (where applicable)

Name of designated premises supervisor where the premises licence authorises for the supply of alcohol

Mr James Sinclair Caldwell Telfer

State whether access to the premises by children is restricted or prohibited

NO

Signed:



Date: 20 December 2021

Name: Damian Wilkins
Position: Health Protection Manager
For and on behalf of the Licensing Authority of North Northamptonshire Council
T: 0300 126 3000 | DD: 01832 742102 | Web: www.northnorthants.gov.uk

Premises licence **15/00781/LAPNEW**
Our Issue Reference No: 21/01709/LATRAN

Important Note: All hours stated on this licence relate only to permissions under the Licensing Act 2003 these may conflict with those permitted in the planning permission for the premises. Please check your current planning permissions before trading. Where opening hours exceed planning

restrictions, failure to abide by planning permissions may lead to legal action under planning legislation.

Appendix 3

Representation One

From: Bev Blackburn <[REDACTED]>

Sent: Monday, July 1, 2024 1:08 PM

To: CBC Env Health <EnvHealth.cbc@northnorthants.gov.uk>

Cc: [REDACTED]; [REDACTED]; [REDACTED];

[REDACTED]; [REDACTED];

<[REDACTED]>; [REDACTED]

Subject: Objection to White Hart late licence 24/01083/LAPVAR

Afternoon

Detailed below is the objection to the late licence application for White Hart, High Street, Corby.

Regrettably, Corby Old Village Neighbourhood Association (COVNA) cannot support the request to extend the licence until 3:00am on a Friday and Saturday night.

Corby Old Village is a designated conservation area in the town and consequently, we work very hard to maintain this. This area is not the correct area for late night drinking and the inevitable events that drinking late creates.

The White Hart is directly opposite residential homes and they tolerate the midnight licence (although to be fair they would prefer an earlier closing time) but anything after this is not supported. The residential homes are occupied mainly by elderly residents and NNC does have a duty of care towards their health and well being. Having shouting/drinking/arguments etc which 'go with the territory' of late licences is not acceptable for a residential area, with homes not more than 10 yards from the front of the pub. We have experienced all of these negative human behaviours, first hand, from The Village Inn when it was a late licence establishment, along with other disgraceful behaviours i.e. sex acts and drug taking/trading.

Within the old village we have recently had to work very hard to challenge late licences (The Village being one), this area is a residential, conservation part of Corby and should be treated with the respect it deserves. A late licence attracts undesirable people and behaviours as, unfortunately, people don't remain in charge of their emotions when drinking etc for hours on end.

COVNA understands the difficulties licensed establishments are facing within the hospitality trade and we do not want to see them fail. But, we do believe that a midnight licence is plenty for a residential establishment.

We, also, understand that McCarthy & Stone are seeking planning for a retirement home complex which would be 50 yards from the pub, so again we have to respect the duty of care for elderly residents.

Also, we do know that a Travelodge is also planned next to the train station, which would bring in trade for the White Hart. A late licence is not necessary until 3 for the establishment to increase it's footfall.

In summary, Corby Old Village Neighbourhood Association (COVNA) cannot support this application to extend the licencing hours of the White Hart, due to the impact this will have on our community and it's residents.

Thank you for reading this objection and please will you advise me of the outcome of the request.

Regards

Beverley Blackburn

COVNA Secretary

Representation Two

From: Gail Christy <[REDACTED]>

Sent: Monday, July 1, 2024 10:18:24 PM

To: CBC Env Health <EnvHealth.cbc@northnorthants.gov.uk>

Cc: Bev Blackburn <[REDACTED]>

Subject: Objection to White Hart's late licence application:24/01083/LAPVAR

I live directly opposite the White Hart in Corby Old Village at no. [REDACTED] High Street.

I have been in contact before re the inappropriate and illegal broadcasting of music from the speakers fixed to the external walls of this building - in a conservation area!

I have lived here for 8 years. Naturally I made enquiries about what to expect from a public house so near to the property I was considering to buy. I was told it was a 'Family Pub' & all music (in doors) finished by 11:00 & crowds usually dispersed by 12:00. I was quite happy with that...and have been quite happy here until the arrival of the present landlords. The constant external music broadcasts made me think I was living in an all-day disco - and the thought now that this 'Family Pub' is about to become a 'Night Club' fills me with horror.

The crowds leaving the pub do not disperse when the venue closes. The recent melee involving a large number of police is a case in point. I can't remember the exact date but a policeman called on me two days after the incident to see if my camera had recorded anything. He told me it was serious: two cases of GBH & eight of ABH. And this occurred when the sale of alcohol was alleged to have stopped at 11:00 p.m. What am I to expect if this continues until 3:00 a.m.?

May I remind you this is Corby Old VILLAGE ! Is a small residential area the right place for a Night Club. There is a high number of elderly people in the vicinity (I am 80 years old) and the Assisted Living houses at No.19 & 21 High Street are very close.

I cannot support the granting of this extension & object to it strongly.

I have heard that the restaurant side of the White Hart's business has good reviews & is well thought of. I wish the landlords every success with that.

Yours sincerely,

Gail Christy

Representation Three

From: Shirley Almond <[REDACTED]>
Sent: Monday, July 1, 2024 9:46:30 PM
To: CBC Env Health <EnvHealth.cbc@northnorthants.gov.uk>
Subject: White hart

[CAUTION: EXTERNAL EMAIL] This email originated from outside of the organisation. Do not click links or open attachments unless you recognise the sender and know the content is safe.

Good evening

Re: white hart pub Corby old village- hello I live 10 meters away from the white hart pub, I have just found out that they have put in to extend the drinking hours until 3am at the weekends-this is absolutely disgusting- the people of the village have enough hassle from the pub - shouting/fighting/cars blocking driveway's/drug deals going on outside our houses/constant smell of drugs/ I can not even open my windows at night because of the noise/smell!!

I am not as old as most of the people in the near vicinity but it is sooo annoying

Please can you pass this on to licencing?

Many thanks

A very worried resident

On 2 Jul 2024, at 11:15, Ian Shaw <ian.shaw@northnorthants.gov.uk> wrote:

Dear Madam,

Thank you for your email, however as you have not included you full name and address, also a contact telephone number we are unable to accept this objection.

If you wish to provide these details, then your objection will be considered as to its validity.

Response to above email from Shirley Almond

Mrs Shirley Almond

[REDACTED] Dixon Walk

Corby NN171UR

[REDACTED]

Sent from my iPhone

Email dated Thu 04/07/2024 15:11, response to my email of 4 Jul 2024, at 13:51, which is shown in the full report.

The white hart is not a night club, so why why why would they even think of being open until early hours in the morning (absolutely ridiculous)

Do you actually know how close it is to residential properties?

Would yourself or the landlord/landlady want this happening not even 10 yards away from their home?

This page is intentionally left blank

Archived: 18 July 2024 12:07:04
From: [Bryan David \(PC\)](#)
Sent: Tue, 2 Jul 2024 12:03:02
To: [Ian Shaw](#)
Subject: The White Hart.
Sensitivity: Normal

[CAUTION: EXTERNAL EMAIL] This email originated from outside of the organisation. Do not click links or open attachments unless you recognise the sender and know the content is safe.

Hello Ian,

Here you go.

At 00:30 on 19/05/2024 Police received a report from a member of the public stating that there was a large fight occurring outside THE WHITE HART PUBLIC HOUSE in CORBY with several people injured at the scene. Officers arrived shortly afterwards with numerous walking wounded around the area and one adult male laying on the floor in the doorway of the pub with a significant laceration to the back of his head. Officers were advised that the offenders had fled from the pub towards the train station but due to the risk of the male with the head laceration the decision was made to remain and ensure that he was cared for while another crew was requested to attend and search for any offenders.

It was stated by people at the scene that several people had attended the pub for a night out, and that one of them had exited the front of the pub and had begun to urinate up the wall outside. A member of staff at the pub challenged the male outside about this, the male became instantly aggressive and proceeded to throw the member of staff into the doorway of the pub. The noise from the commotion led to numerous other people including several friends of the male urinating coming outside of the pub and engaging in a fight. Prior to any Police arrival, all of the believed group fled the scene and were not present. None of the people reporting assaults were able to identify any of the suspects involved in the incident, and none of them were able to specifically identify which of the males had assaulted them. None of the witnesses were able to provide any specific details or name any of the persons involved.

The premises has alcohol sales until midnight and close of business at 12:30am Mon-Sun, although there were persons still present at 00:30am this would have been within the terms of the licence it has not be ascertained whether the premises were operating outside of this, or closing down for the evening.

There have been no recorded licensing issues made to the police since the 19/05/2024 and the police licensing database has been searched to the beginning of 2024 with no recorded incidents at the premises.

David Bryan | PC 113

Alcohol Licensing Constable

Wellingborough Police Station | Local Policing
(Telephone 101 or 03000 111 222 (if outside of Northamptonshire) [REDACTED])

: Email david.bryan@northants.police.uk

Address Northamptonshire Police Wellingborough Police Station Midland Road Wellingborough NN8 1HF
'Fighting crime, protecting people through intelligence led policing'



This email should be treated as "OFFICIAL" unless where marked "OFFICIAL – SENSITIVE".



Imagery ©2024 Maxar Technologies, Map data ©2024 20 m

Measure distance
Total distance: 31.02 m (101.76 ft)

This page is intentionally left blank

Appendix



Imagery ©2024 Maxar Technologies, Map data ©2024 50 m

Measure distance
Total distance: 76.56 m (251.19 ft)

This page is intentionally left blank